

371

United States Department of the Interior
National Park Service



National Register of Historic Places
Registration Form

This form is for use in nominating or requesting determinations for individual properties and districts. See instructions in *How to Complete the National Register of Historic Places Registration Form* (National Register Bulletin 16A). Complete each item by marking "x" in the appropriate box or by entering the information requested. If an item does not apply to the property being documented, enter "N/A" for "not applicable." For functions, architectural classification, materials, and areas of significance, enter only categories and subcategories from the instructions. Place additional entries and narrative items on continuation sheets (NPS Form 10-900a). Use a typewriter, word processor, or computer, to complete all items.

1. Name of Property

historic name Hanover Town Library

other names/site number Etna Library

2. Location

street & number 130 Etna Road NA not for publication

city or town Hanover NA vicinity

state New Hampshire code NH county Grafton code 009 zip code 03755

3. State/Federal Agency Certification

As the designated authority under the National Historic Preservation Act, as amended, I hereby certify that this nomination request for determination of eligibility meets the documentation standards for registering properties in the National Register of Historic Places and meets the procedural and professional requirements set forth in 36 CFR Part 60. In my opinion, the property meets does not meet the National Register criteria. I recommend that this property be considered significant nationally statewide locally. (See continuation sheet for additional comments.)

Nancy C. Muller DIRECTOR 3/20/97
Signature of certifying official/Title Date

NEW HAMPSHIRE
State of Federal agency and bureau

In my opinion, the property meets does not meet the National Register criteria. (See continuation sheet for additional comments.)

Signature of certifying official/Title Date

State or Federal agency and bureau

4. National Park Service Certification

I hereby certify that the property is:

- entered in the National Register.
 See continuation sheet.
- determined eligible for the National Register
 See continuation sheet.
- determined not eligible for the National Register.
- removed from the National Register.
- other, (explain:)

Signature of the Keeper

Date of Action

B. A. Savage

4/25/97

Hanover
Town Library
Name of Property

Grafton County,
New Hampshire
County and State

5. Classification

Ownership of Property
(Check as many boxes as apply)

- private
- public-local
- public-State
- public-Federal

Category of Property
(Check only one box)

- building(s)
- district
- site
- structure
- object

Number of Resources within Property
(Do not include previously listed resources in the count.)

Contributing	Noncontributing	
1	0	buildings
0	0	sites
0	0	structures
0	0	objects
1	0	Total

Name of related multiple property listing
(Enter "N/A" if property is not part of a multiple property listing.)

N/A

Number of contributing resources previously listed in the National Register

N/A

6. Function or Use

Historic Functions
(Enter categories from instructions)

EDUCATION: library

Current Functions
(Enter categories from instructions)

EDUCATION: library

7. Description

Architectural Classification
(Enter categories from instructions)

Colonial Revival

Materials
(Enter categories from instructions)

foundation STONE: Granite

walls BRICK

roof SLATE

other WOOD: Portico

Narrative Description

(Describe the historic and current condition of the property on one or more continuation sheets.)

The Hanover Town Library, commonly referred to as the "Etna Library" because of the village within Hanover where the property is located, is a small but well detailed early twentieth-century rural library building. Not only is the building in excellent condition, but it is almost completely unaltered from the time when it was originally constructed in 1905. Likewise, both the site and the overall setting of the property is little altered, still retaining the integrity and feel of a small rural village.

Sitting up on a grassy knoll immediately to the east of Etna Road, the library building is visually an integral part of the Etna Village area although it is surrounded on three sides by a small hillside family farm. In fact, the 50' x 80' parcel that the building occupies was originally a part of the adjacent farm, having been subdivided in 1903, in anticipation of constructing a future town library facility.

United States Department of the Interior
National Park ServiceNational Register of Historic Places
Continuation SheetSection number 7 Page 1Hanover Town Library
Grafton County, NH

Narrative Description (continued)

The single story brick building measures 33'-10" wide by 27'-10" deep, not including the small 10'-6" x 5'-6" extension from the rear wall that was originally constructed as a vault for town documents and records. The front entrance into the building is identified and protected by a small 5'-6" x 9'-0" classical portico.

The 12/10 pitch roof is framed in a hip configuration with a combination of wood trusses and rafters, and covered with slate shingles. The exterior walls are of brick construction, 8" thick by 12 feet high, laid in running or stretcher bond. Native rough dressed granite is used for windows and the rear door opening lintels and window sills. Also, the same granite is used as the facing on the exposed areas of the foundations, but, the below grade portions are of a simpler rubble stone.

The windows are tall, narrow, wood double hung units set into the building envelope in pairs with a wide center mullion, and a small fixed single pane unit is located directly above the operable sash, all quite typical for the period of this type of structure. Recently aluminum combination storm/screen units have been added, however, the work was done in a very neat fashion.

The front doorway assembly is a typical period design, of wood construction with sidelights, recessed into the building approximately 2 1/2 feet. The masonry of the exterior wall is carried above the entrance opening by a shallow segmental arch.

As mentioned earlier, a small portico of simple classical design protrudes from the front face of the building, giving protection and definition to the front entrance. Wood columns of the tuscan order, resting on a dressed granite base, support a pleasantly proportioned entablature and cornice also of wood construction.

With the exception of a present day small toilet room that was originally constructed as a vault, the interior consists of one large reading room. The walls are lath and plaster, applied over a 2"x 4" stud frame constructed inside of the exterior brick walls. Because a 2" air space was provided for between the wood and masonry wall construction, for reason of maintaining a dry and easily heated interior environment, the total exterior wall thickness is 14". The beaded matched board ceiling is varnished hazel-wood as is all of the interior trim and book shelving.

Since the building's construction in 1905, it has been electrified (gas Chandeliers first illuminating its interior), and an oil-fired, ducted, hot air furnace in the basement has replaced the original wood or coal stove located on the main floor. However, other than these changes and the alterations previously noted herein, the library building remains almost exactly as designed and constructed eighty-nine years ago. Likewise, other than the paved highway in front of the building and the similarly paved driveway immediately to the south leading to the adjacent grouping of farm buildings, the setting remains unchanged from what is visible in photographs of the library taken shortly

**United States Department of the Interior
National Park Service**

**National Register of Historic Places
Continuation Sheet**

Section number 7 Page 2

Hanover Town Library
Grafton County

Narrative Description (continued)

after its construction.

Architecturally, this building is a very good period example of a building type from the turn of the century, representing an era of tremendous growth, development and interest in small community libraries. Similar buildings can be found within surrounding towns, most notably Norwich, Vermont, whose small brick facility is of almost the same date of construction. In addition to Hanover's building being a fine example, is the fact that it has survived the years, escaping serious alteration or destruction, so that it can now be studied and enjoyed in its original state and setting.

CRANE'S THESIS PAPER
EXTRA 100% RAG

8. Statement of Significance

Applicable National Register Criteria

(Mark "x" in one or more boxes for the criteria qualifying the property for National Register listing.)

- A** Property is associated with events that have made a significant contribution to the broad patterns of our history.
- B** Property is associated with the lives of persons significant in our past.
- C** Property embodies the distinctive characteristics of a type, period, or method of construction or represents the work of a master, or possesses high artistic values, or represents a significant and distinguishable entity whose components lack individual distinction.
- D** Property has yielded, or is likely to yield, information important in prehistory or history.

Criteria Considerations

(Mark "x" in all the boxes that apply.)

Property is:

- A** owned by a religious institution or used for religious purposes.
- B** removed from its original location.
- C** a birthplace or grave.
- D** a cemetery.
- E** a reconstructed building, object, or structure.
- F** a commemorative property.
- G** less than 50 years of age or achieved significance within the past 50 years.

Narrative Statement of Significance

(Explain the significance of the property on one or more continuation sheets.)

9. Major Bibliographical References

Bibliography

(Cite the books, articles, and other sources used in preparing this form on one or more continuation sheets.)

Previous documentation on file (NPS):

- preliminary determination of individual listing (36 CFR 67) has been requested
- previously listed in the National Register
- previously determined eligible by the National Register
- designated a National Historic Landmark
- recorded by Historic American Buildings Survey # _____
- recorded by Historic American Engineering Record # _____

Areas of Significance

(Enter categories from instructions)

EDUCATION

Period of Significance

1905 - 1946

Significant Dates

1905

Significant Person

(Complete if Criterion B is marked above)

N/A

Cultural Affiliation

N/A

Architect/Builder

Dartmouth College
Engineering Professor
Robert E. Fletcher;
Town of Hanover,
Builder

Primary location of additional data:

- State Historic Preservation Office
- Other State agency
- Federal agency
- Local government
- University
- Other

Name of repository:

Name of Property _____

County and State _____

10. Geographical Data

Acreage of Property .09 (less than one)

UTM References

(Place additional UTM references on a continuation sheet.)

1	1 8	7 2 4 1 7 7	4 8 4 1 5 1 10
	Zone	Easting	Northing
2			

3			
	Zone	Easting	Northing
4			

See continuation sheet

Verbal Boundary Description

(Describe the boundaries of the property on a continuation sheet.)

Boundary Justification

(Explain why the boundaries were selected on a continuation sheet.)

11. Form Prepared By

name/title Frank J. Barrett, Jr.; Town of Hanover Code Administrator

organization Town of Hanover date March 1, 1996

Municipal Building

street & number 41 South Main Street telephone (603) 643-0711

P.O. Box 483

city or town Hanover state NH zip code 03755

Additional Documentation

Submit the following items with the completed form:

Continuation Sheets

Maps

A **USGS map** (7.5 or 15 minute series) indicating the property's location.

A **Sketch map** for historic districts and properties having large acreage or numerous resources.

Photographs

Representative **black and white photographs** of the property.

Additional items

(Check with the SHPO or FPO for any additional items)

Property Owner

(Complete this item at the request of SHPO or FPO.)

name Town of Hanover

street & number 41 South Main Street telephone (603) 643-0700

P.O. Box 483

city or town Hanover state NH zip code 03755

Paperwork Reduction Act Statement: This information is being collected for applications to the National Register of Historic Places to nominate properties for listing or determine eligibility for listing, to list properties, and to amend existing listings. Response to this request is required to obtain a benefit in accordance with the National Historic Preservation Act, as amended (16 U.S.C. 470 et seq.).

Estimated Burden Statement: Public reporting burden for this form is estimated to average 18.1 hours per response including time for reviewing instructions, gathering and maintaining data, and completing and reviewing the form. Direct comments regarding this burden estimate or any aspect of this form to the Chief, Administrative Services Division, National Park Service, P.O. Box 37127, Washington, DC 20013-7127; and the Office of Management and Budget, Paperwork Reductions Projects (1024-0018), Washington, DC 20503.

United States Department of the Interior
National Park Service

National Register of Historic Places Continuation Sheet

Section number 8 Page 3

Hanover Town Library
Grafton County, NH

Narrative Statement of Significance

The Hanover Town Library is eligible for the National Register under criterion A for education. It is historically significant as the Town's first library building constructed for that purpose, and which continues to serve the village of Etna in that capacity. It was built, and continues to be owned and staffed by the Town of Hanover. The library possesses integrity of location, setting, design, materials, workmanship, feeling, and association for the period 1905 - 1946, the date of construction to the 50-year cut off date.

With the exception of Dartmouth College's early book collections, the first Town library, available to the community at large, was not located within the Hanover Village area, as one might initially expect, but rather out in present day Etna, or Mill Village as it was known prior to 1884. However, on second thought, it is the Etna and Hanover Center area that is situated far more towards the Town's geographical center, and it was also the location of the Town's government and annual meeting until well into this century.

The first library was established on June 12, 1801 and apparently had a reasonably large collection of books for that time. Throughout the nineteenth century the library went through several incorporations as well as various locations around the Etna area. However, it was at the March 1898 Town Meeting that "The Hanover Free Library" was established with the election of three library trustees, and the books from previous efforts at establishing and maintaining a public library were given over to their custody.

In establishing this new library, the Town was able to take advantage of grant monies available thru the New Hampshire Library Act of 1891. As a result, by the dawn of this century, the book collection had grown substantially and a critical housing problem was making itself apparent.

Therefore, at the annual March, 1905 Town Meeting, it was voted to raise an additional \$600.00, to be combined with previous appropriations made by the Selectmen and various donations of the citizenry, for the construction of a new brick library building. A second vote was taken to instruct the library trustees to build a fire-proof vault, in connection with the new building, for the proper storage and preservation of Town documents.

Robert E. Fletcher, a noted professor of engineering at Dartmouth's Thayer School, was on the library's board of trustees and drew the architectural plans for the building. The facility's 50' x 80' building lot had been purchased two years earlier in 1903 for fifty dollars, and construction was completed by the end of the 1905 year. In an effort to save money on an already tight budget, the trustees elected to act as their own

**United States Department of the Interior
National Park Service**

**National Register of Historic Places
Continuation Sheet**

Section number 8 Page 4

Hanover Town Library
Grafton County, NH

Narrative Statement of Significance (continued)

general contractor, coordinating and superintending the work themselves. When the new facility was finally completed, the total cost, including the vault, stood at \$2,822.11. The following year, a glowing and detailed report of its construction appeared within the pages of the 1906 Town Report.

Since the date of the buildings completion, the building has been used and enjoyed by many as a small, local community library. However, other than some electrical and heating equipment updating, and the addition of a small toilet/lavatory installed within the old vault area, the building remains vertically unaltered and almost frozen in time.

CRANE'S THESIS PAPER

EXTRA 100% RAG

**United States Department of the Interior
National Park Service**

**National Register of Historic Places
Continuation Sheet**

Section number 9 Page 5

Hanover Town Library
Grafton County, NH

Bibilography

- * Various Town of Hanover Annual Town Reports, from the period 1898 to 1906.
- * A History of the Town of Hanover, N.H.; by John King Lord; The Dartmouth Press; 1928.
- * Hanover, New Hampshire, A Bicentennial Book; Essays in Celebration of the Town's 200th Anniversary; Edited by Francis Lane Childs; Hanover, 1961

United States Department of the Interior
National Park Service

National Register of Historic Places
Continuation Sheet

Section number 10 Page 6

Hanover Town Library
Grafton County, NH

Verbal Boundary Description: Boundaries of the nominated property are indicated on the attached sketch map.

Boundary Justification: The nominated parcel is that upon which the building was originally constructed, as per deed dated August 15, 1903 conveying the parcel to the Town of Hanover, described as follows:

"...A certain tract or parcel of land situated in said Hanover bounded and described as follows: to wit: Beginning at a bound in the westerly line of the highway leading from Hanover Center to Hanover, thence running southerly in said westerly line Fifty-Five feet to a bound, thence turning at right angles and running westerly Eighty feet to a bound, thence turning at right angles and running northerly Fifty-Five feet to a bound, thence turning at right angles and running easterly Eighty feet to the bound begun at..."

CRANE'S THESIS PAPER
EXTRA 100% RAG

United States Department of the Interior
National Park Service

National Register of Historic Places
Continuation Sheet

Section number 10 Page 7

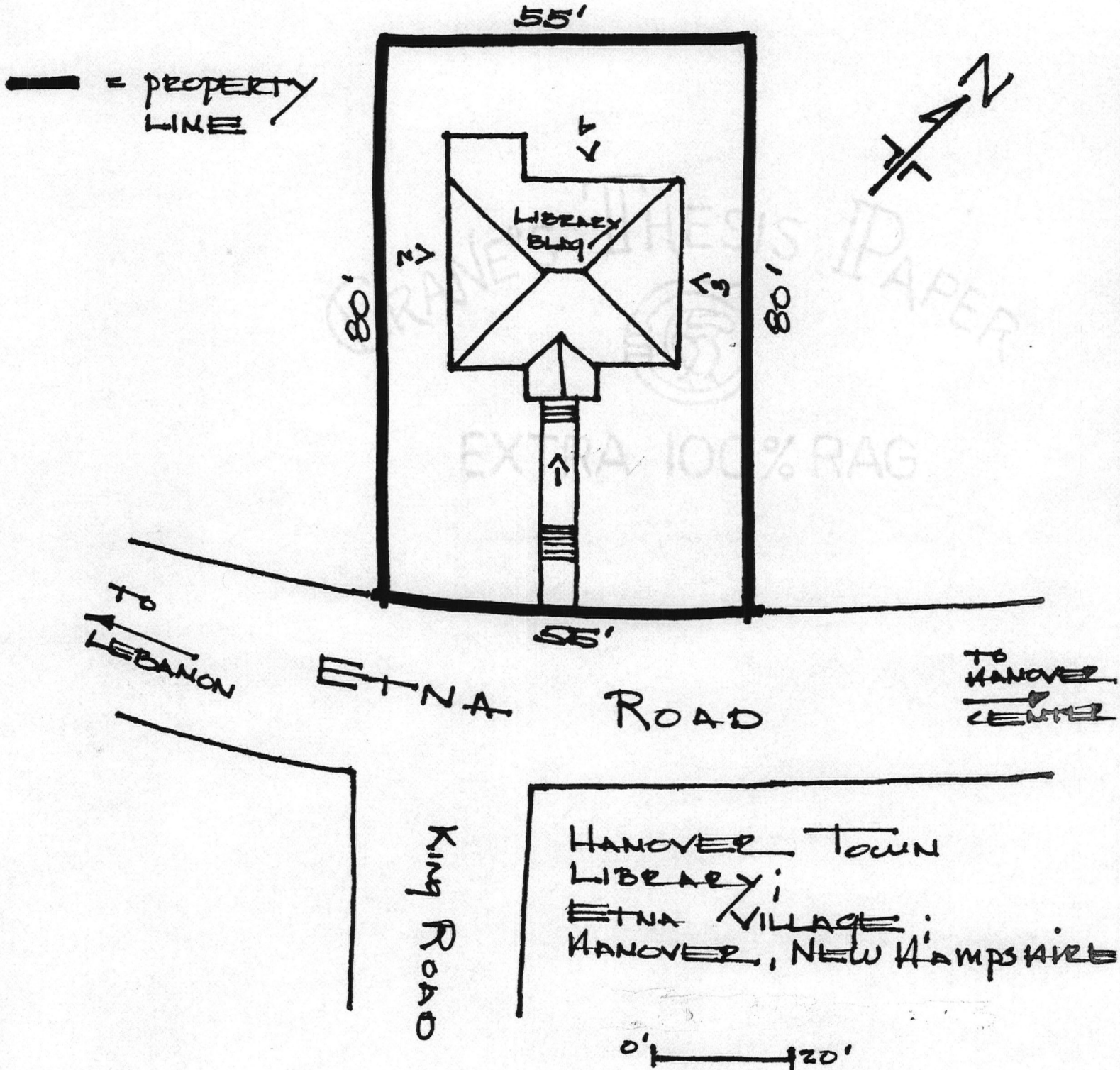

UNITED STATES DEPARTMENT OF THE INTERIOR
NATIONAL PARK SERVICE

NATIONAL REGISTER OF HISTORIC PLACES
EVALUATION/RETURN SHEET

REQUESTED ACTION: NOMINATION

PROPERTY NAME: Hanover Town Library

MULTIPLE NAME:

STATE & COUNTY: NEW HAMPSHIRE, Grafton

DATE RECEIVED: 3/28/97 DATE OF PENDING LIST: 4/09/97
DATE OF 16TH DAY: 4/25/97 DATE OF 45TH DAY: 5/12/97
DATE OF WEEKLY LIST:

REFERENCE NUMBER: 97000371

NOMINATOR: STATE

REASONS FOR REVIEW:

APPEAL: N DATA PROBLEM: N LANDSCAPE: N LESS THAN 50 YEARS: N
OTHER: N PDIL: N PERIOD: N PROGRAM UNAPPROVED: N
REQUEST: N SAMPLE: N SLR DRAFT: N NATIONAL: N

COMMENT WAIVER: N

ACCEPT RETURN REJECT 4/25/97 DATE

ABSTRACT/SUMMARY COMMENTS:

RECOM./CRITERIA _____

REVIEWER _____ DISCIPLINE _____

TELEPHONE _____ DATE _____

DOCUMENTATION see attached comments Y/N see attached SLR Y/N

TOWN LIBRARY 1905



HANOVER Town LIBRARY

130 ETNA ROAD

HANOVER,

GRAFTON COUNTY

NEW HAMPSHIRE

RICHARD D. HANCOCK, DIRECTOR

PUBLIC WORKS, PHOTOGRAPHER

of

SUMMER 1994

NEGATIVE FILED AT HANOVER MUNICIPAL

BUILDING

EAST (FRONT) ELEVATION

PHOTOGRAPH NUMBER 1 of 6



HANOVER Town LIBRARY
130 ~~ETNA~~ ROAD

HANOVER,
GRATTON COUNTY
NEW HAMPSHIRE

RICHARD D. HAUGER, DIRECTOR of
PUBLIC WORKS, PHOTOGRAPHER

SUMMER 1994

NEGATIVE FILED AT HANOVER

MUNICIPAL BUILDING

SOUTH (LEFT) ELEVATION

PHOTOGRAPH NUMBER 2 of 6



HANOVER TOWN LIBRARY
130 ETNA ROAD
HANOVER,
GRAFTON COUNTY
NEW HAMPSHIRE

RICHARD D. HAUGER, DIRECTOR OF
PUBLIC WORKS, PHOTOGRAPHER

SUMMER 1994

NEGATIVE FILED AT HANOVER
MUNICIPAL BUILDING

NOTA (~~21941~~) ELEVATION

PHOTOGRAPH NUMBER 3 OF 6



HANOVER TOWN LIBRARY

130 ETNA ROAD

HANOVER,
GRAFTON COUNTY

NEW HAMPSHIRE

RICHARD D. HAUGER, DIRECTOR OF
PUBLIC WORKS, PHOTOGRAPHER

SUMMER 1994

NEGATIVE FILED AT HANOVER
MUNICIPAL BUILDING

WEST (REAR) ELEVATION

PHOTOGRAPH NUMBER 4 OF 6



HANOVER TOWN LIBRARY

130 ETNA ROAD

HANOVER

GRAFTON COUNTY

NEW HAMPSHIRE

RICHARD D. HAUGER, DIRECTOR OF

PUBLIC WORKS, PHOTOGRAPHER

SUMMER 1994

NEGATIVE FILED AT HANOVER MUNICIPAL
BUILDING

INTERIOR SIDE OF FRONT ENTRANCE

PHOTOGRAPH NUMBER 5 OF 6



HANOVER TOWN LIBRARY

130 ETNA ROAD

HANOVER

GRAFTON COUNTY

NEW HAMPSHIRE

RICHARD D. HAUGER, DIRECTOR OF
PUBLIC WORKS, PHOTOGRAPHER

SUMMER 1994

NEGATIVE FILED AT HANOVER

MUNICIPAL BUILDING

CEILING DETAIL

PHOTOGRAPH NUMBER 6 OF 6

Canaan

NEW HAMPSHIRE-VERMONT

1:25 000-scale metric
topographic map

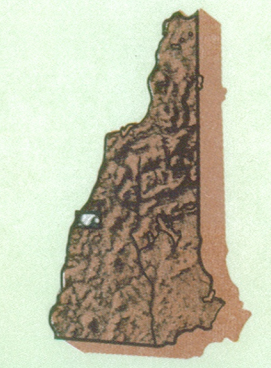

7.5 X 15 MINUTE QUADRANGLE
SHOWING

- Contours and elevations in meters
- Highways, roads and other manmade structures
- Water features
- Woodland areas
- Geographic names

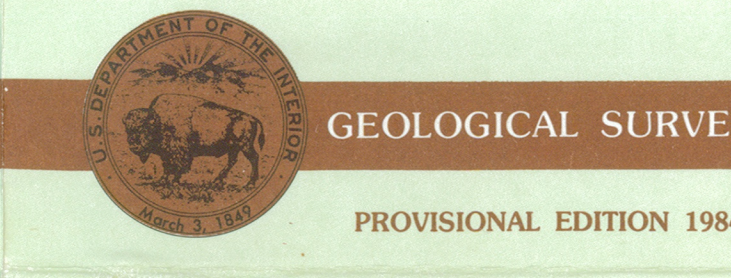

PRODUCED BY THE UNITED STATES GEOLOGICAL SURVEY CONTROL BY U.S.G.S., NORSONMA, AND STATE OF NEW HAMPSHIRE AGENCIES
 COMPILED FROM AERIAL PHOTOGRAPHS TAKEN 1977 FIELD CHECKED 1988 MAP EDITED 1988
 PROJECTION 1983 METRIC UNIVERSAL TRANSVERSE MERCATOR GRID 1000-METER UNIVERSAL TRANSVERSE MERCATOR GRID 1000-FOOT STATE GRID TICKS NEW HAMPSHIRE AND VERMONT UTM GRID DECLINATION 1995 EAST 1983 MAGNETIC NORTH DECLINATION 1995 WEST VERTICAL DATUM NATIONAL GEODETIC VERTICAL DATUM OF 1989 HORIZONTAL DATUM 1983 NORTH AMERICAN DATUM
 To place on the predicted North American Datum of 1983, move the projection lines as shown by dashed corner ticks (4 meters south and 38 meters west)
 There may be private inholdings within the boundaries of any National or State reservations shown on this map
 Gray tint indicates area in which selected buildings are shown

CONTOUR INTERVAL 6 METERS
 CONTROL ELEVATIONS SHOWN TO THE NEAREST 0.1 METER OTHER ELEVATIONS SHOWN TO THE NEAREST METER

THIS MAP COMPLIES WITH NATIONAL MAP ACCURACY STANDARDS

Meters	Feet
1	3.2808
2	6.5617
3	9.8425
4	13.1234
5	16.4042
6	19.6850
7	22.9659
8	26.2467
9	29.5276
10	32.8084

ADJOINING MAPS	1	2	3
	4	5	
	6	7	8

1 South Stratford (7.5)
 2a Lamoine (7.5)
 2b Swanton Mountain (7.5)
 3 Winooski (7.5)
 4 Hanover (7.5)
 5 Mt. Coddington (7.5)
 6 North Stratford (7.5)
 7 Enfield Center
 8 Danbury

FOR SALE BY U.S. GEOLOGICAL SURVEY DENVER, COLORADO 80225, OR RESTON, VIRGINIA 22092

ROAD LEGEND

Improved Road
Unimproved Road
Trail

○ Interstate Route □ U.S. Route ○ State Route

PROVISIONAL MAP
 Produced from original manuscript drawings. Information shown as of date of field check



HANOVER TOWN LIBRARY
 HANOVER NH
 2 EASTING NORTHING
 18 724-177 4841.510

JAN 28 1997

HANOVER HISTORICAL SOCIETY

POST OFFICE BOX 142
HANOVER, NEW HAMPSHIRE 03755

January 23, 1997

Dear Sir/Madam:

The Hanover Historical Society fully endorses the nomination of the Hanover Town Library and the Great Hollow Road Stone Arch Bridge to the National Register of Historic Places. We feel that these properties are significant to the town's early history, and we hope that they may serve to encourage the listing of other historically important Hanover properties before these are moved, destroyed, or inappropriately altered. We strongly urge the addition of both the library and the bridge to the National Register.

Sincerely,

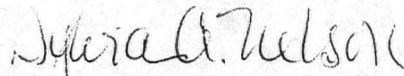

Sylvia Allen Nelson,
President

Department of Historical Resources
19 Pillsbury Street
P.O. Box 2043
Concord, NH 03302-2043

WEBSTER COTTAGE 32 NORTH MAIN STREET